



April 9, 2021

Bob Sly  
Smith Group  
1700 New York Avenue, Suite 100  
Washington, DC 20006

**SUBJECT: Hazardous Materials Inspection  
Moultrie Courthouse, Fourth Floor**

Dear Mr. Sly,

Maxximus Environmental, Inc. has completed a hazardous materials survey of selected portions of the fourth floor of the Moultrie Courthouse. The survey included an asbestos inspection, a lead-based paint inspection, and a survey for universal wastes.

Separate reports for asbestos and lead are attached to this summary.

The following quantities of universal waste were identified:

Type of Waste	Quantity
Fluorescent lamps – 2’ U-tubes	227
Fluorescent lamps – 4’ tubes	73
Compact fluorescent lamps	12
Ballasts	252
LED fixtures	90
Exit signs assumed with batteries	18
Smoke detectors assumed with a radioactive source	25
Refrigerators (ozone depleting compounds)	2
Water coolers (ozone depleting compounds)	1

Sincerely,  
LIFE Seeds, Inc.

Edmond R. VandenBosche  
Certified Industrial Hygienist  
443-846-4748 (cell)

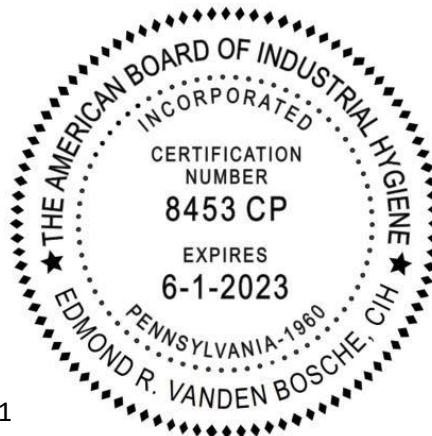

Enclosures

Asbestos Inspection Report dated April 9, 2021  
Lead Inspection Report dated January 27, 2021



March 5, 2021 Revised April 9, 2021

Bob Sly  
Smith Group  
1700 New York Avenue, Suite 100  
Washington, DC 20006

**SUBJECT: Asbestos Inspection  
Moultrie Courthouse  
Fourth Floor**

Dear Mr. Sly,

This letter reports on an asbestos inspection of the above referenced property.

The first attached sketch provides a reference for suite numbers as used in this report.

There is an additional sketch for each type of asbestos containing material identified. The areas with asbestos containing material are highlighted.

#### **Executive Summary**

LIFE Seeds has completed an asbestos inspection at the above address. The samples were collected on January 27, 2021 by Jeffre Powell. Samples were analyzed at AMA Analytical in Lanham, MD, an NVLAP accredited laboratory.

The following materials were determined to contain asbestos

<b>Table 1 Summary of Asbestos Containing Materials</b>				
<b>Material</b>	<b>Description</b>	<b>EPA Cat.</b>	<b>Qty</b>	<b>Samples</b>
Joint compound		NF 2	22,384 SF	5001, 5035
Floor tile and mastic	White under carpet	NF 1	8,408 SF	5004, 5005
Duct seam sealant	Red	NF 2	925 LF	5007, 5040
Duct insulation seam sealant	White	NF 2	Included above	5024, 5030

NF means not friable.

\*Quantity of drywall associated with joint compound

#### **Methods**

Samples were collected at the frequency required by OSHA and EPA regulations following the requirements set out in the EPA regulation known as the Asbestos Hazard Emergency Response Act (AHERA) following procedures required by this regulation.



The location of positive materials is indicated on the sketch. The quantity of positive material was determined by take-offs provided by the Smith Group. The quantities are estimates. Abatement contractors should field verify any quantity that they require more accurately.

A chain of custody was completed and accompanied the samples to the laboratory. Samples were delivered to AMA Analytical Services, Inc.

## **Results**

Sample results are presented in Table 2 on the next page. Yellow highlights are samples that were determined to contain asbestos.

No damaged asbestos continuing material was identified.

## **Discussion**

Joint compound is positive in some samples and negative in some samples. Figure 4 depicts areas where samples were positive with a yellow highlight. Areas where samples were negative are either white or orange. White areas were reported by DC Courts to have all new sheetrock at the time of the last renovation. Orange areas have been renovated by were reported by DC Courts to possible have some original walls in place. Walls in orange areas are to be handled as ACM except that the contractor may elect to collect two samples from each wall to document on a wall by wall basis if the joint compound contains asbestos.

Red duct seam sealant was observed in 4450, the hallway south of 4450, east of 4455, and 4539. In 4539 it is a 1 foot length of duct extending in from 4475A. Remaining ductwork is new and has gray seam sealant. Sample 5016 represents the negative seam sealant.

Duct insulation in the area where the metal ducts have red seam sealant has white seam sealant on the fiberglass. The white seam sealant contains asbestos.

Floor tile was observed under the carpet throughout suite 4450. In the pantry, there is about 60 square feet of a top layer of tile and a bottom layer of tile. The bottom layer in the pantry was negative in the one sample collected. Because of the hidden nature of this lower layer, it will be difficult to do a good job of collecting confirmatory samples. Because of the small amount of this material, it is recommended to remove it as asbestos along with the floor tile in the rest of suite 4450.



**Table 2 - Asbestos Sample Results**

ID	Material	Description	Location	Result
5001	Joint compound		4450-8	2% chrysotile
5002	Drywall		4450-8	No Asbestos Detected
5003	Base board mastic	Brown	4450-8	No Asbestos Detected
5004	Floor tile	White under carpet	4450-8	2% chrysotile
5005	Floor tile mastic	Black	4450-8	4% chrysotile
5006	Fireproofing	White	4450-8	No Asbestos Detected
5007	Duct seam sealant	Red	4450-8	5% chrysotile
5008	Ceiling tile	White	4450-8	No Asbestos Detected
5009	Ceiling tile	White	4450	No Asbestos Detected
5010	Floor tile	Lower layer	4450-pantry	No Asbestos Detected
5010A	Mastic	Yellow	4450-pantry	No Asbestos Detected
5010B	Mastic	Yellow	4450-pantry	No Asbestos Detected
5011	Floor tile	White	4450-pantry	No Asbestos Detected
5011 B	Mastic	Yellow	4450-pantry	No Asbestos Detected
5012	Drywall		Hall outside 4450	No Asbestos Detected
5013	Joint compound		Hall outside 4450	No Asbestos Detected
5014	Drywall		4485	No Asbestos Detected
5015	Joint compound		4485	No Asbestos Detected
5016	Duct seam sealant	Gray	4485	No Asbestos Detected
5017	Fireproofing	Brown	4485	No Asbestos Detected
5018	Ceiling tile	White	4485	No Asbestos Detected
5019	Firestop	Red	4485	No Asbestos Detected
5020	Base board mastic		4485	No Asbestos Detected
5021	Floor tile	Blue	4485	No Asbestos Detected
5022	Joint compound		4455	No Asbestos Detected
5023	Firestop	Red	4455	No Asbestos Detected
5024	Duct seam sealant	White	4455	5% chrysotile
5025	Fireproofing	Beige	4455	No Asbestos Detected
5026	Fireproofing	Beige	4455	No Asbestos Detected
5027	Ceiling tile		4455	No Asbestos Detected
5028	Base board mastic	White	4455	No Asbestos Detected
5029	Ceiling tile	White	East of 4455	No Asbestos Detected
5030	Duct insulation seam sealant	White	East of 4455	5% chrysotile
5031	Base board mastic	White	East of 4455	No Asbestos Detected
5032	Ceiling tile		West of 4475A	No Asbestos Detected
5033	Drywall		West of 4475A	No Asbestos Detected
5034	Joint compound		West of 4475A	No Asbestos Detected
5035	Joint compound		4475A	2% chrysotile
5036	Drywall		4475A	No Asbestos Detected
5037	Drywall		4539	No Asbestos Detected
5038	Joint compound		4539	No Asbestos Detected



5039	Ceiling tile		4539	No Asbestos Detected
5040	Duct sealant	Red	4539	5% chrysotile
5041	Fireproofing		4539	No Asbestos Detected

**Recommendations**

1. Remove asbestos containing materials that will be impacted by construction following all state and federal regulations.
2. Two additional joint compound samples are recommended in each suite with a negative result. Joint compound in each suite can then be treated independently. The alternative is to consider all joint compound positive.
3. Asbestos containing materials that will not be impacted by construction can be managed in place or removed as you prefer.

Sincerely,  
LIFE Seeds, Inc.

Edmond R. VandenBosche  
Certified Industrial Hygienist  
443-846-4748 (cell)



Enclosures

Figures 1 through 4  
Laboratory Certificate of Analysis



Figure 1 - Suite Numbers in Asbestos Report





Figure 2 - Locations with ACM Floor Tile (Red highlight)

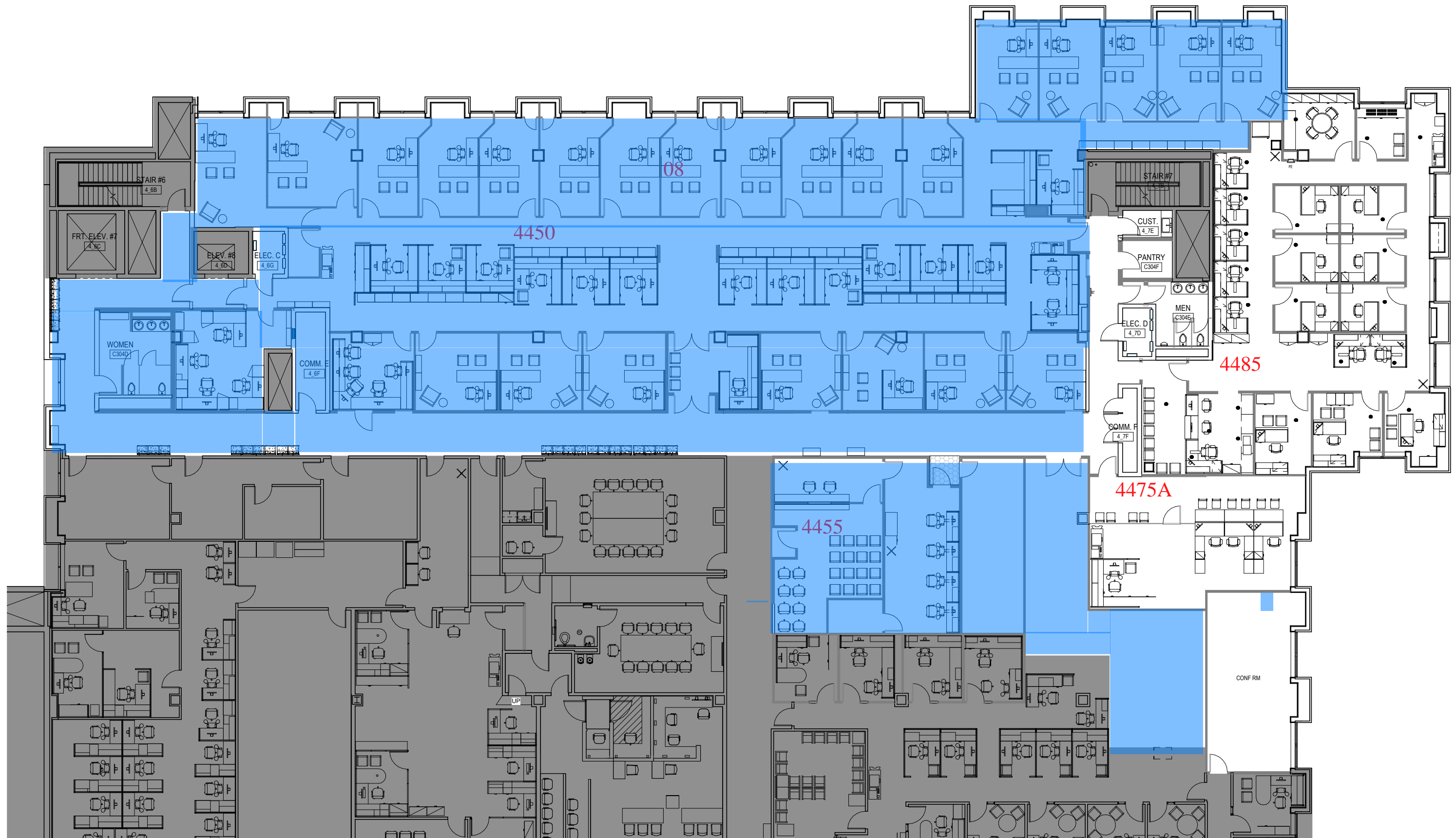

Figure 3 - Locations with ACM Duct Seam Sealant (Blue highlight)





Figure 4 - Locations with ACM Joint Compound (Yellow highlight)



# CERTIFICATE OF ANALYSIS

**Chain of Custody:** 625008  
**Client:** Life Seeds  
**Address:** 1900 Chelsea Road  
Baltimore, MD 21216  
**Attention:** Ellen Lucas

**Job Name:** Moultrie Court House 4th Floor  
**Job Location:** 500 Indiana Avenue NW, Washington,  
DC  
**Job Number:** 12721  
**P.O. Number:** Not Provided

**Date Submitted:** 01/28/2021  
**Date Analyzed:** 02/04/2021  
**Report Date:** 02/04/2021  
**Date Sampled:** 01/27/2021  
**Person Submitting:** Jeff Powell

## Summary of Polarized Light Microscopy

AMA Sample Number	Client Sample Number	Total Asbestos	Chrysotile Percent	Amosite Percent	Crocidolite Percent	Other Asbestos Percent	Mineral Wool Percent	Fiberglass Percent	Organic Percent	Synthetic Percent	Other Percent	Particulate Percent	Sample Type	Sample Color	Homogeneity	Analyst ID	Comments
625008-1	5001-44508-01	2	2	--	--	--	--	--	--	--	--	98	JC	White	Homogeneous	SW	
625008-2	5002-44508-02	NAD	--	--	--	--	--	--	10	--	--	90	DW	Multi	Layered	SW	
625008-3	5003-45508-03	NAD	--	--	--	--	--	--	TR	--	--	100	MS	Brown	Homogeneous	SW	
625008-4	5004-44508-04	2	2	--	--	--	--	--	--	--	--	98	FT	White	Homogeneous	SW	
625008-5	5005-4408-05	4	4	--	--	--	--	--	--	--	--	96	MS	Black	Homogeneous	SW	
625008-6	5006-4408-6	NAD	--	--	--	--	--	--	20	--	--	80	SPO	Gray	Homogeneous	SW	
625008-7	5007-4408-7	5	5	--	--	--	--	--	--	--	--	95	DS	Red	Homogeneous	SW	
625008-8	5008-44508-8	NAD	--	--	--	--	30	--	30	--	--	40	CT	Multi	Layered	SW	
625008-9	5009-4450	NAD	--	--	--	--	--	--	40	--	--	60	SPO	Gray	Homogeneous	SW	
625008-10	5010-4450	NAD	--	--	--	--	--	--	--	--	--	100	FT	Tan	Homogeneous	SW	
625008-10A	5010-4450	NAD	--	--	--	--	--	--	TR	--	--	100	MS	Yellow	Homogeneous	SW	
625008-10B	5010-4450	NAD	--	--	--	--	--	--	TR	--	--	100	MS	Yellow	Homogeneous	SW	
625008-11	5011	NAD	--	--	--	--	--	--	--	--	--	100	FT	White	Homogeneous	SW	
625008-11A	5011	NAD	--	--	--	--	--	--	TR	--	--	100	MS	Yellow	Homogeneous	SW	
625008-12	5012	NAD	--	--	--	--	--	--	10	--	--	90	DW	Multi	Layered	SW	
625008-13	5013	NAD	--	--	--	--	--	--	--	--	--	100	JC	White	Homogeneous	SW	
625008-14	5014-4485-18	NAD	--	--	--	--	--	--	10	--	--	90	DW	Multi	Layered	SW	
625008-15	5015-4485-18	NAD	--	--	--	--	--	--	10	--	--	90	JC	White	Homogeneous	SW	
625008-16	5016-4485 Near 18	NAD	--	--	--	--	--	--	--	--	--	100	SLT	Gray	Homogeneous	SW	
625008-17	5017-4485 Near 18	NAD	--	--	--	--	--	--	40	--	--	60	SPO	Brown	Homogeneous	SW	
625008-18	5018-4485 Near 18	NAD	--	--	--	--	30	--	30	--	--	40	CT	Gray	Homogeneous	SW	



# CERTIFICATE OF ANALYSIS

**Chain of Custody:** 625008  
**Client:** Life Seeds  
**Address:** 1900 Chelsea Road  
Baltimore, MD 21216  
**Attention:** Ellen Lucas

**Job Name:** Moultrie Court House 4th Floor  
**Job Location:** 500 Indiana Avenue NW, Washington,  
DC  
**Job Number:** 12721  
**P.O. Number:** Not Provided

**Date Submitted:** 01/28/2021  
**Date Analyzed:** 02/04/2021  
**Report Date:** 02/04/2021  
**Date Sampled:** 01/27/2021  
**Person Submitting:** Jeff Powell

## Summary of Polarized Light Microscopy

AMA Sample Number	Client Sample Number	Total Asbestos	Chrysotile Percent	Amosite Percent	Crocidolite Percent	Other Asbestos Percent	Mineral Wool Percent	Fiberglass Percent	Organic Percent	Synthetic Percent	Other Percent	Particulate Percent	Sample Type	Sample Color	Homogeneity	Analyst ID	Comments
625008-19	5019-4485 Near 18	NAD	--	--	--	--	30	--	30	--	--	40	FS	Red	Homogeneous	SW	
625008-20	5020-4485-18	NAD	--	--	--	--	--	--	--	--	--	100	MS	Tan	Homogeneous	SW	
625008-21	5021-4485	NAD	--	--	--	--	--	--	10	--	--	90	FT	Blue	Homogeneous	SW	
625008-22	5022-4455 Suite 3	NAD	--	--	--	--	--	--	--	--	--	100	JC	White	Homogeneous	SW	
625008-23	5023-4455	NAD	--	--	--	--	--	--	TR	--	--	100	FS	Red	Homogeneous	SW	
625008-24	5024-4455	5	5	--	--	--	--	--	--	--	--	95	DS	Off-White	Homogeneous	SW	
625008-25	5025-4455	NAD	--	--	--	--	70	--	10	--	--	20	SPO	Beige	Homogeneous	SW	
625008-26	5026-4455	NAD	--	--	--	--	--	--	40	--	--	60	SPO	Beige	Homogeneous	SW	
625008-27	5027-4455	NAD	--	--	--	--	20	--	40	--	--	40	CT	Multi	Layered	SW	
625008-28	5028-4455	NAD	--	--	--	--	--	--	--	--	--	100	MS	White	Homogeneous	SW	
625008-29	5029-East of 4455	NAD	--	--	--	--	30	--	30	--	--	40	CT	Multi	Layered	SW	
625008-30	5030--East of 4455	5	5	--	--	--	--	TR	--	--	--	95	SLT	White	Homogeneous	SW	
625008-31	5031-East of 4455	NAD	--	--	--	--	--	--	TR	--	--	100	MS	White	Homogeneous	SW	
625008-32	5032-West of 4475a	NAD	--	--	--	--	30	--	30	--	--	40	CT	Multi	Layered	SW	
625008-33	5033-West of 4475a	NAD	--	--	--	--	--	--	10	--	--	90	DW	Multi	Layered	SW	
625008-34	5034-West of 4475a	NAD	--	--	--	--	--	--	--	--	--	100	JC	White	Homogeneous	SW	
625008-35	5035-4475A	2	2	--	--	--	--	--	--	--	--	98	JC	White	Homogeneous	SW	
625008-36	5036-4475A	NAD	--	--	--	--	--	--	10	--	--	90	DW	Multi	Layered	SW	
625008-37	5037-4539	NAD	--	--	--	--	--	--	10	--	--	90	DW	Multi	Layered	SW	
625008-38	5038-4539	NAD	--	--	--	--	--	--	--	--	--	100	JC	White	Homogeneous	SW	
625008-39	5039-4539	NAD	--	--	--	--	40	--	20	--	--	40	CT	Multi	Layered	SW	
625008-40	5040-4539	5	5	--	--	--	--	--	--	--	--	95	DS	Red	Homogeneous	SW	



# CERTIFICATE OF ANALYSIS

**Chain of Custody:** 625008  
**Client:** Life Seeds  
**Address:** 1900 Chelsea Road  
Baltimore, MD 21216  
**Attention:** Ellen Lucas

**Job Name:** Moultrie Court House 4th Floor  
**Job Location:** 500 Indiana Avenue NW, Washington,  
DC  
**Job Number:** 12721  
**P.O. Number:** Not Provided

**Date Submitted:** 01/28/2021  
**Date Analyzed:** 02/04/2021  
**Report Date:** 02/04/2021  
**Date Sampled:** 01/27/2021  
**Person Submitting:** Jeff Powell

## Summary of Polarized Light Microscopy

AMA Sample Number	Client Sample Number	Total Asbestos	Chrysotile Percent	Amosite Percent	Crocidolite Percent	Other Asbestos Percent	Mineral Wool Percent	Fiberglass Percent	Organic Percent	Synthetic Percent	Other Percent	Particulate Percent	Sample Type	Sample Color	Homogeneity	Analyst ID	Comments
625008-41	5041-4539	NAD	--	--	--	--	--	--	40	--	--	60	SPO	Tan	Homogeneous	SW	

The following footnotes only apply to those samples which the total asbestos result is flagged with a note number.

<sup>1</sup> TEM RECOMMENDATION - Please note, due to resolution limitations with optical microscopy and/or interference from matrix components of this sample, results which are reported via PLM as negative or trace (<1%) for asbestos may contain a significant quantity of asbestos. It is recommended that the additional analytical technique of TEM be used to check for asbestos fibers below the resolution limits of optical microscopy.

<sup>2</sup> MATRIX REDUCTION RECOMMENDATION - Please note, due to interference from the matrix components of this sample, results which are reported via PLM as negative or trace (<1%) for asbestos may contain a significant quantity of asbestos which is obscured from view. It is recommended that the additional preparation technique of gravimetric reduction be performed on this sample to minimize the obscuring effects of matrix components, followed by reanalysis by PLM and/or TEM.

Analysis Method - EPA/600/R-93/116 dated July 1993

NAD = "No Asbestos Detected" TR = "Trace equals less than 1% of this component"

Uncertainty: For samples containing asbestos in range of 1-10% the CV is 0.43, 11-35% CV=0.55, >35 CV=0.23. All results are to be considered preliminary and subject to change unless signed by the Technical Director or Deputy.

**Analyst(s):** Surat Watson

**Technical Director** Michael Greenberg

This report applies only to the sample, or samples, investigated and is not necessarily indicative of the quality or condition of apparently identical or similar products. As a mutual protection to clients, the public, and these Laboratories, this report is submitted and accepted for the exclusive use of the client to whom it is addressed and upon the condition that it is not to be used, in whole or in part, in any advertising or publicity matter without prior written authorization from us. Sample types, locations, and collection protocols are based upon the information provided by the persons submitting them and, unless collected by personnel of these Laboratories, we expressly disclaim any knowledge and liability for the accuracy and completeness of this information. Residual sample material will be discarded in accordance with the appropriate regulatory guidelines, unless otherwise requested by the client. NVLAP accreditation applies only to polarized light microscopy of bulk samples and transmission electron microscopy of AHERA air samples. This report must not be used to claim, and does not imply product certification, approval, or endorsement by NVLAP or any agency of the Federal Government. All rights reserved. AMA Analytical Services, Inc.



2



**AMA Analytical Services, Inc.**

For a Free Quote, visit [www.ama-lab.com](http://www.ama-lab.com)  
 AHA TEL AP: (410) 470-1100 NY TEL AP: (914) 992-2000  
 4475 Popbes Blvd. • Lanham, MD 20706  
 (301) 459-2600 • (800) 316-0961 • Fax (301) 459-2613

**CHAIN OF CUSTODY**

(Please Refer To Encl. Number For Inquiries)

6025008

**Mailing/Billing Information:**

1. Client Name: Maxximus Environmental / LIFE Seeds Inc  
 2. Address 1: 1010 Rockville Pike suite 200/ 1900 Chelsea Road  
 3. Address 2: Rockville Maryland Baltimore Maryland 21216  
 4. Address 3: EMAIL to: vianevada@msn.com and ellen.lucas@lifeseed  
 5. Phone #: 443 301 3533 Fax #: \_\_\_\_\_

**Submittal Information:**

1. Job Name: Moultrie Court House 4th floor  
 2. Job Location: 500 Indiana Avenue N.W. Washington D.C  
 3. Job #: 12721 P.O. #: \_\_\_\_\_  
 4. Contact Person: Ellen Cell: \_\_\_\_\_  
 5. Collected by: Jeffrey Powell Cell: 2023594540

Reporting Info (Results provided as soon as technically feasible. If no TAT/Reporting Info is provided, AMA will assign defaults of 5-Day and email to contacts on file.

<b>AFTER HOURS (must be pre-scheduled)</b> <input type="checkbox"/> 4 Hours <input type="checkbox"/> Late Night <input type="checkbox"/> Immediate Date Due: _____ <input type="checkbox"/> 24 Hours Time Due: _____ Comments: _____		<b>NORMAL BUSINESS HOURS</b> <input type="checkbox"/> 4 Hours <input type="checkbox"/> 3 Day <input type="checkbox"/> Results Required By Noon <input type="checkbox"/> Same Day <input type="checkbox"/> 5 Day (Additional fee may apply) <input type="checkbox"/> Next Day <input type="checkbox"/> 7 Day <input type="checkbox"/> Due Due: _____ <input type="checkbox"/> 7 Day		<b>REPORT TO:</b> <input type="checkbox"/> Email: _____ <input type="checkbox"/> Email 2: _____ <input type="checkbox"/> Verbal: _____
--	--	--	--	---

**Asbestos Analysis**

PCM Air - Please Indicate Filter Type: \_\_\_\_\_  
 NIOSH 7400 (QTY) \_\_\_\_\_  
 Fiberglass (QTY) \_\_\_\_\_  
 HLM Air - Please Indicate Filter Type: \_\_\_\_\_  
 MHRN (QTY) \_\_\_\_\_  
 NIOSH 4902 (QTY) \_\_\_\_\_  
 Other (Specify) \_\_\_\_\_ (QTY) \_\_\_\_\_  
 PML Bulk: 40  
 EPA 9001 Visual Estimate (QTY)  Pos Stop  
 EPA Pump Count (QTY) \_\_\_\_\_  
 NY State Table 195-1 (QTY) \_\_\_\_\_  
 Gray Radiation ELAP 1980 (QTY) \_\_\_\_\_  
 Other (Specify) \_\_\_\_\_ (QTY) \_\_\_\_\_

**HLM Bulk**

ELAP 198-4 Charfield (QTY) \_\_\_\_\_  
 NY State PML HLM (QTY) \_\_\_\_\_  
 Residential Ash (QTY) \_\_\_\_\_  
 Vermiculite (QTY) \_\_\_\_\_  
**HLM Dust:**  
 Qual. (pre-abs) Vacuum Dust (QTY) \_\_\_\_\_  
 Quant. (sealed) Vacuum D5/D5-95 (QTY) \_\_\_\_\_  
 Quant. (sealed) Dust D6/D6-99 (QTY) \_\_\_\_\_

**HLM Water**

Qual. (pre-abs) (QTY) \_\_\_\_\_  
 ELAP 198-2/4 PA 190-2 (QTY) \_\_\_\_\_  
 EPA 100-1 (QTY) \_\_\_\_\_

All samples received in good condition unless otherwise noted.  
 Lab use only (TEM Water samples \_\_\_\_\_ C)

If field indicators are submitted they will be analyzed in compliance section.

**Metals Analysis**

Pb Paint Chip  % by Weight (QTY)  mg/cm<sup>2</sup> (QTY)  
 Pb Dust Wipe (swipe type) (QTY) \_\_\_\_\_  
 Pb Air (QTY) \_\_\_\_\_  
 Pb Soil/Solid (QTY) \_\_\_\_\_  
 Pb TCLP (QTY) \_\_\_\_\_  
 Drinking Water  Pb (QTY)  Cu (QTY) \_\_\_\_\_  
 Waste Water  Pb (QTY)  Cu (QTY) \_\_\_\_\_  
 Pb Furnace Material (QTY) \_\_\_\_\_

**Fungal Analysis**

Collection Apparatus for Spore Traps Air Samples \_\_\_\_\_  
 Collection Media \_\_\_\_\_  
 Spore Trap (QTY) \_\_\_\_\_  Surface Vacuum Dust (QTY) \_\_\_\_\_  
 Surface Swab (QTY) \_\_\_\_\_  
 Surface Tap (QTY) \_\_\_\_\_  
 Other (Specify) (QTY) \_\_\_\_\_

**MISC:**  
 Asbestos ASTM D7521 PML (Qual) PML (Quant) PMLTEM (Qual) PMLTEM (Quant)

\*It is recommended that blank samples be submitted with all air and surface samples

SAMPLE INFORMATION		DATE/TIME	ANALYSIS										MATRIX				COMMENTS/SPECIAL INSTRUCTIONS
CLIENT ID #	SAMPLE LOCATION/ID		TV	TCV	TV	TCV	TV	TCV	TV	TCV	TV	TCV	TV	TCV	TV	TCV	
5014-4485-18	DW white	1/27/21															
5015-4485-18	JC blue																
5016-4485	Near 18 Grey Spray sealant ceiling																
5017-4485	near 18 Ceiling Brown Spay insulation brown																
5018-4485	near 18 Ceiling tile white																
5019-4485	across 18 Ceiling Red fire stop																
5020-4485	- 18 B board mastic																
5021-4485	Kitchen Blue floor tile																
5022-4455	suite 3 1 <sup>st</sup> rm on rt- JC white																
5023-4455	Over back dr red fire stop																

Relinquished by: <u>Jeffrey Powell</u>	Print Name	Signature	Date: <u>01/27/21</u>	Time	Shipping Information
Received by: _____					<input type="checkbox"/> UPS <input type="checkbox"/> FedEx <input type="checkbox"/> Other <input type="checkbox"/> EMS <input type="checkbox"/> Registered Mail <input type="checkbox"/> Signature Required <input type="checkbox"/> Insured <input type="checkbox"/> Tracking







January 27th, 2021

Name: LIFE Seeds, Inc.

Date of Construction: Pre-1978

Inspection Site: 500 Indiana Ave NW Washington DC 20001  
 Inspection Date: January 27th, 2021  
 XRF Device: Heuresis Pb200i  
 XRF Serial Number: 1774  
 Operators: Charlotte Kimball, DC20-9896  
 Company Accred. #: DC12-6678

Per your request, specific components were tested to determine if those components had a sufficient amount of lead to meet the District of Columbia's statutory definition of lead. According to the District of Columbia regulatory standard Lead in quantities greater than 1.0 mg/cm<sup>2</sup> is lead. Lead was NOT found in paint on any of the components.

Lead in a quantity less than the District of Columbia threshold may have also been identified. Please see the attached results to see how much lead was identified in each component tested.

Area	Component (s)
No Lead Paint Found in Any Area Tested	No Lead Paint Found on Any Component Tested

Please contact AVETS should you have any questions about these finding or have further concerns about the lead-based paint or mold related to this property.

Thank You

*Charlotte Kimball*

Charlotte Kimball, Inspector

DC20-9896



LEAD-SAFE AND HEALTHY HOMES DIVISION  
LEAD COMPLIANCE & ENFORCEMENT BRANCH



NAME: Charlotte Kimball

CLASS CODE: Inspector

EXPIRATION DATE: 12-18-2022

CARD NUMBER: DC20-9896

A handwritten signature in black ink that reads "Tommy Wells". The signature is written in a cursive style.

**Tommy Wells**  
Director

# 500 Indiana Ave NW Washington D.C. 20001

AVETS Inc.  
6234 Georgia Avenue, N.W.  
Washington D.C

INSPECTION DATE: 1/27/2021

INSTRUMENT TYPE: Heuresis Corp.  
Pb200i XRF Lead Paint Analyzer  
1774

ACTION LEVEL: 1.0 mg/cm<sup>2</sup>

Job ID: court house

STATEMENT: Inspection limited to a general survey of 4 areas (diagram attached), components were selected to represent similar surfaces throughout the areas, rather than testing of every surface.

Reading #	Concentration	Result	Job Id	-->RoomChoice	Structure	Substrate	Wall	Location	Component
1	1.1	Positive	court house	Calibration		Wood			
2	1.2	Positive	court house	Calibration		Wood			
3	1.1	Positive	court house	Calibration		Wood			
4	-0.1	Negative	court house	Suite 1	29	Wood	C		Door Frame
5	-0.1	Negative	court house	Suite 1	29	Wood	C		Door
6	0	Negative	court house	Suite 1	29	Drywall	D		Wall
7	0	Negative	court house	Suite 1	29	Wood	C		Window Frame
8	-0.2	Negative	court house	Suite 1	29	Drywall	D		Wall
9	-0.1	Negative	court house	Suite 1	29	Drywall	A		Wall
10	0	Negative	court house	Suite 1	1	Drywall	C		Wall
11	0.1	Negative	court house	Suite 1	1	Plastic	C		Trim
12	0.1	Negative	court house	Suite 1	1	Wood	D		Door
13	0.2	Negative	court house	Suite 1	1	Metal	D		Door Frame
14	0.2	Negative	court house	Suite 1	28	Metal	D		Door Frame
15	0	Negative	court house	Suite 1	28	Plastic	A		Trim
16	0	Negative	court house	Suite 1	28	Drywall	A		Wall
17	0.2	Negative	court house	Suite 1	5	Wood	A	1	Door
18	0.1	Negative	court house	Suite 1	5	Metal	A	1	Door Frame
19	0	Negative	court house	Suite 1	5	Drywall	A		Wall
20	0.1	Negative	court house	Suite 1	5	Drywall	D		Trim
21	0.1	Negative	court house	Suite 1	5	Wood	A	2	Door
22	0.2	Negative	court house	Suite 1	5	Wood	A	2	Door Frame
23	0.2	Negative	court house	Suite 1	12	Metal	A		Door Frame
24	0	Negative	court house	Suite 1	12	Wood	A		Door
25	0.1	Negative	court house	Suite 1	12	Drywall	A		Wall
26	0.1	Negative	court house	Suite 1	12	Plastic	A		Trim
27	0	Negative	court house	Suite 1	29	Drywall			column
28	0.1	Negative	court house	Suite 1	14	Wood	A		Door
29	0.2	Negative	court house	Suite 1	14	Metal	A		Door Frame
30	0.2	Negative	court house	Suite 1	14	Drywall	A		Wall
31	-0.2	Negative	court house	Suite 1	14	Wood	A	2	Door Frame
32	0	Negative	court house	Suite 1	14	Wood	A	2	Door
33	0.1	Negative	court house	Suite 1	14	Wood	A		Closet Shelf



34	-0.1	Negative	court house	Suite 1	29	Drywall	B	Wall
35	-0.1	Negative	court house	Suite 1	29	Drywall	B	Wall
36	0.1	Negative	court house	Suite 1	19	Wood	C	Door Frame
37	0	Negative	court house	Suite 1	19	Wood	C	Door
38	0.2	Negative	court house	Suite 1	19	Drywall	C	Wall
39	0	Negative	court house	Suite 1	19	Plastic	C	Trim
40	0	Negative	court house	Hallway		Drywall	A	Wall
41	0.2	Negative	court house	Hallway		Plastic	C	Trim
42	0.1	Negative	court house	Hallway		Wood	A	Door
43	0	Negative	court house	Hallway		Metal	A	Door Frame
44	-0.1	Negative	court house	Suite 4	1	Drywall	A	Wall
45	-0.1	Negative	court house	Suite 4	1	Plastic	A	Trim
46	0.2	Negative	court house	Suite 4	1	Wood	A	Door
47	0.2	Negative	court house	Suite 4	1	Metal	C	Door Frame
48	0	Negative	court house	Suite 2	2	Drywall	C	Wall
49	-0.1	Negative	court house	Suite 2	2	Plastic	C	Trim
50	0	Negative	court house	Suite 2	2	Wood	C	Door
51	0.1	Negative	court house	Suite 2	2	Metal	C	Door Frame
52	0	Negative	court house	Suite 2	13	Drywall	C	Wall
53	0.2	Negative	court house	Suite 2	13	Plastic	C	Trim
54	0.2	Negative	court house	Suite 2	6	Wood	B	Door
55	-0.1	Negative	court house	Suite 2	6	Metal	B	Door Frame
56	0.2	Negative	court house	Suite 2	6	Drywall	B	Wall
57	0	Negative	court house	Suite 2	13	Drywall	A	Wall
58	0.1	Negative	court house	Suite 2	9	Wood	A	Door
59	-0.1	Negative	court house	Suite 2	9	Metal	A	Door Frame
60	0.1	Negative	court house	Suite 2	9	Drywall	A	Wall
61	0	Negative	court house	Suite 2	13	Drywall	B	Wall
62	0	Negative	court house	Suite 2	11	Wood	D	Door
63	-0.1	Negative	court house	Suite 2	11	Metal	D	Door Frame
64	0.1	Negative	court house	Suite 2	11	Drywall	D	Wall
65	0	Negative	court house	Suite 2	11	Plastic	D	Trim
66	-0.1	Negative	court house	Suite 2	1	Drywall	D	Wall
67	0	Negative	court house	Suite 2	1	Metal	D	Door Frame

68	0	Negative	court house	Suite 2	1	Wood	D		Door
69	0.1	Negative	court house	Suite 2	1	Plastic	D		Trim
70	-0.1	Negative	court house	Suite 4	2	Drywall	C		Wall
71	0	Negative	court house	Suite 4	2	Concrete	C		floor
72	0.1	Negative	court house	Suite 4	2	Wood	C		Door
73	-0.1	Negative	court house	Suite 4	2	Metal	C		Door Frame
74	0	Negative	court house	Suite 3	4	Drywall	D		Wall
75	0	Negative	court house	Suite 3	4	Wood	D		Chair Rail
76	0	Negative	court house	Suite 3	4	Wood	B		Door
77	0.1	Negative	court house	Suite 3	4	Metal	B		Door Frame
78	0.2	Negative	court house	Suite 3	3	Drywall	A		Wall
79	0.1	Negative	court house	Suite 3	3	Wood	D		Door
80	0.1	Negative	court house	Suite 3	3	Metal	D		Door Frame
81	0	Negative	court house	Suite 3	1	Drywall	A		Wall
82	0.1	Negative	court house	Suite 3	1	Plastic	A		Trim
83	0	Negative	court house	Suite 3	1	Wood	C		Door
84	0.2	Negative	court house	Suite 3	1	Metal	C		Door Frame
85	0.2	Negative	court house	Suite 3	5	Drywall	A		Wall
86	1.1	Positive	court house	Calibration		Wood			
87	1.2	Positive	court house	Calibration		Wood			
88	1.1	Positive	court house	Calibration		Wood			

# Site Diagram

## 500 Indiana Ave NW, 4th Floor

